

SR NO	STAMP CODE	PART NUMBER	DESCRIPTION	L (INCH)	W (INCH)	D (INCH)	T (INCH)
1	WSC42	WSC88-1316	WASHER SQUARE CURVED 8" X8" 13/16" HOLE HDG 1/2" THICKNESS (WSC42)	8	8	13/16	1/2

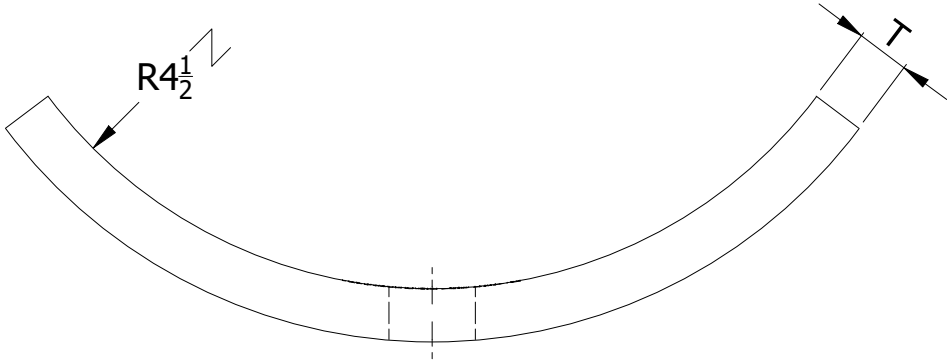
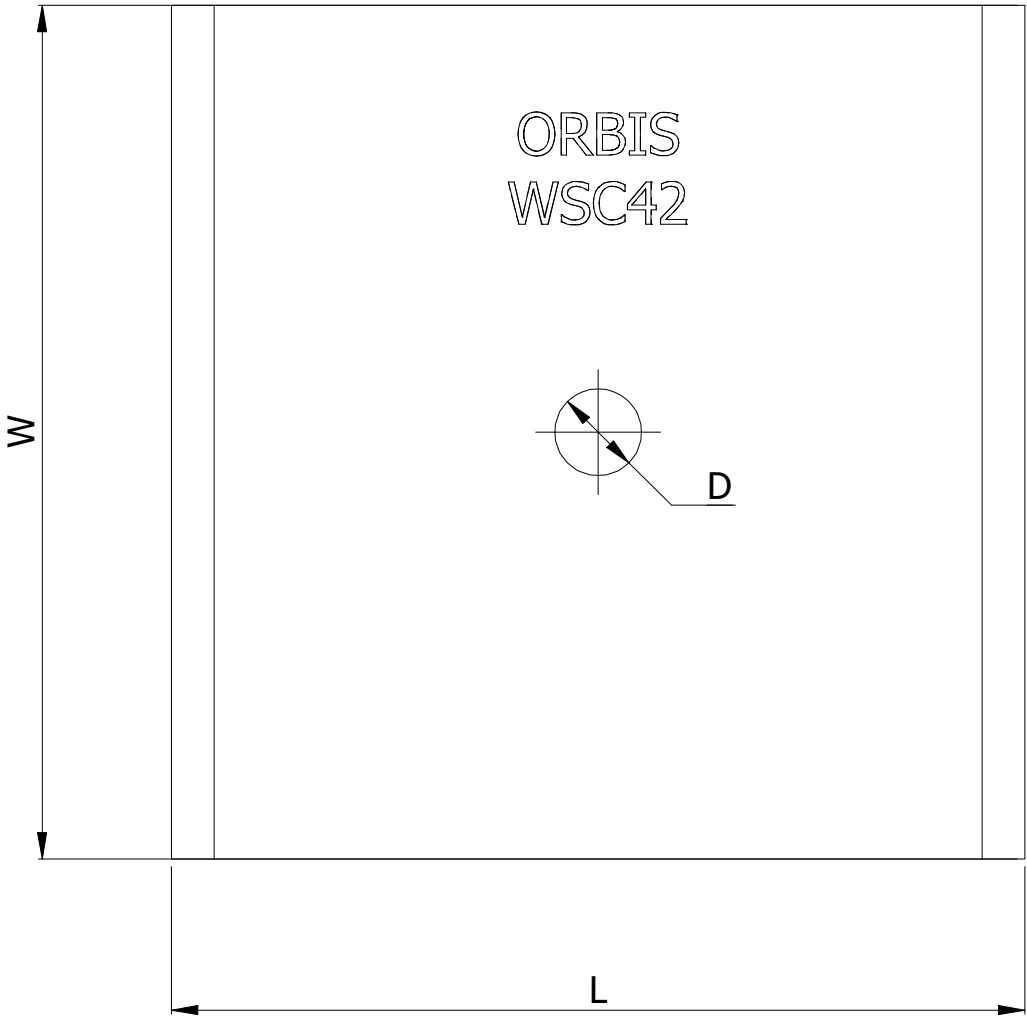

- NOTES:
- HOT DIP GALVANIZED AS PER ASTM A-153
 - MATERIAL - HOT ROLLED STEEL
 - ALL MEASUREMENTS IN INCHES.

THIS DRAWING
CONTAINS
CONFIDENTIAL
INFORMATION
AND IS THE
EXCLUSIVE
PROPERTY OF
ORBIS
MANUFACTURING

ORBIS

DRAWN	MSM	DATE	21-07-2022
APPROVED	DMM	DATE	26-07-2022
REVISION	-		

DRAWING NUMBER

WSC88-1316

DESCRIPTION

WASHER SQUARE CURVED 8" X 8" 13/16"
HOLE HDG 1/2" THICKNESS