

SR NO	STAMP CODE	PART NUMBER	DESCRIPTION	L (INCH)	W (INCH)	D (INCH)	T (INCH)
1	WSC7	WSC3F-1116	WASHER SQUARE CURVED 3"X 3" 11/16" HOLE HDG 3/16" THICKNESS (WSC7)	3	3	11/16	3/16
2	WSC8	WSC3F-1316	WASHER SQUARE CURVED 3"X 3" 13/16" HOLE HDG 3/16" THICKNESS (WSC8)	3	3	13/16	3/16
3	WSC10	WSC3G-916	WASHER SQUARE CURVED 3"X 3" 9/16" HOLE HDG 1/4" THICKNESS (WSC10)	3	3	9/16	1/4
4	WSC11	WSC3G-1116	WASHER SQUARE CURVED 3"X 3" 11/16" HOLE HDG 1/4" THICKNESS (WSC11)	3	3	11/16	1/4
5	WSC12	WSC3G-1316	WASHER SQUARE CURVED 3"X 3" 13/16" HOLE HDG 1/4" THICKNESS (WSC12)	3	3	13/16	1/4
6	WSC13	WSC3G-78	WASHER SQUARE CURVED 3"X 3" 7/8" HOLE HDG 1/4" THICKNESS (WSC13)	3	3	7/8	1/4
7	WSC14	WSC3G-1516	WASHER SQUARE CURVED 3"X 3" 15/16" HOLE HDG 1/4" THICKNESS (WSC14)	3	3	15/16	1/4
8	WSC15	WSC325G-1116	WASHER SQUARE CURVED 3-1/4"X 3-1/4" 11/16" HOLE HDG 1/4" THICKNESS (WSC15)	3-1/4	3-1/4	11/16	1/4
9	WSC16	WSC325G-1316	WASHER SQUARE CURVED 3-1/4"X 3-1/4" 13/16" HOLE HDG 1/4" THICKNESS (WSC16)	3-1/4	3-1/4	13/16	1/4
10	WSC23	WSC325H-1316	WASHER SQUARE CURVED 3-1/4" X 3-1/4" 13/16" HOLE HDG 3/8" THICKNESS (WSC23)	3-1/4	3-1/4	13/16	3/8
11	WSC24	WSC350H-1316	WASHER SQUARE CURVED 3-1/2" X 3-1/2" 13/16" HOLE HDG 3/8" THICKNESS (WSC24)	3-1/2	3-1/2	13/16	3/8
12	WSC25	WSC350H-1516	WASHER SQUARE CURVED 3-1/2" X 3-1/2" 15/16" HOLE HDG 3/8" THICKNESS (WSC25)	3-1/2	3-1/2	15/16	3/8
13	WSC26	WSC350H-118	WASHER SQUARE CURVED 3-1/2" X 3-1/2" 1-1/8" HOLE HDG 3/8" THICKNESS (WSC26)	3-1/2	3-1/2	1-1/8	3/8

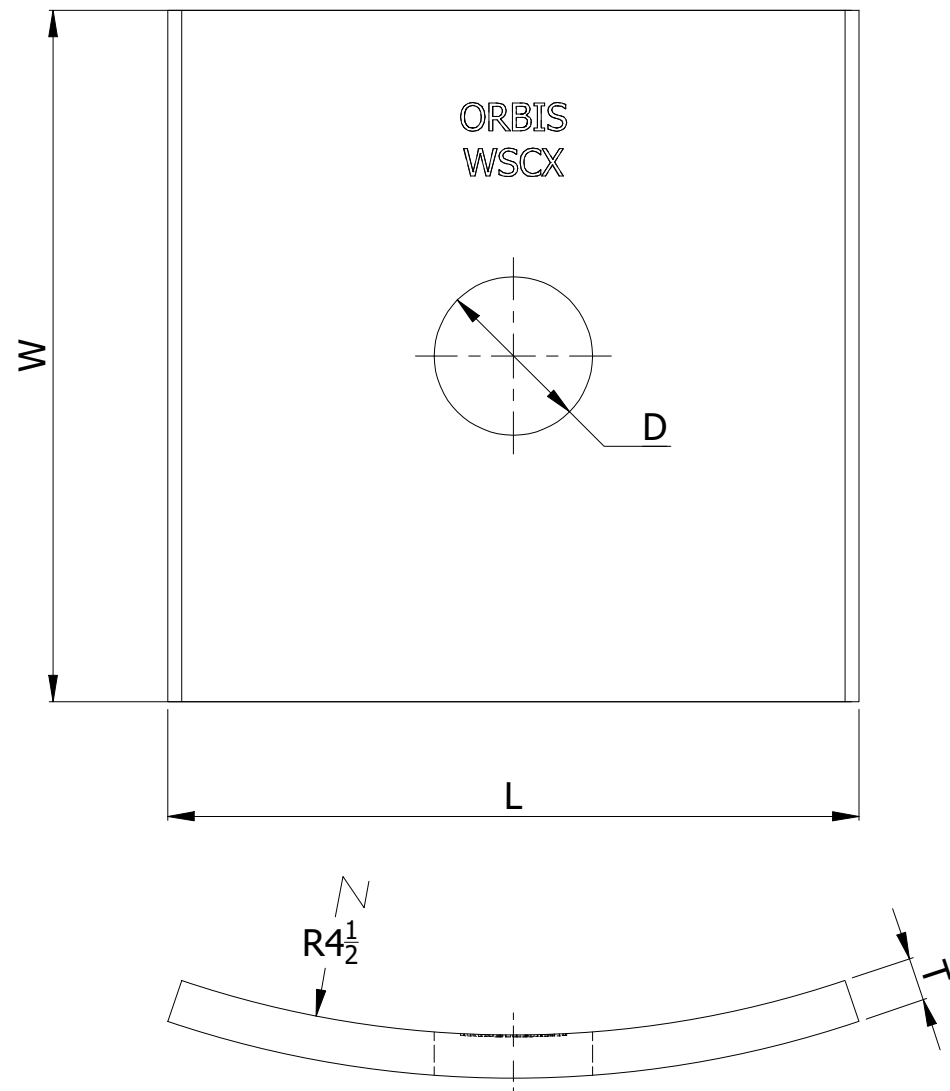

THICKNESS CHART		
FRACTION	DECIMAL	NOMENCLATURE
5/64"	0.07	A
7/64"	0.1	B
1/8"	0.125	C
9/64"	0.14	D
5/32"	0.15	E
3/16	.1875	F
1/4"	.25	G
3/8"	.375	H
7/16"	.4375	I
1/2"	.5	J

NOTES:

- HOT DIP GALVANIZED AS PER ASTM A-153
- MATERIAL - HOT ROLLED STEEL
- ALL MEASUREMENTS IN INCHES.

THIS DRAWING
CONTAINS
CONFIDENTIAL
INFORMATION
AND IS THE
EXCLUSIVE
PROPERTY OF
ORBIS
MANUFACTURING

ORBIS

DRAWN	MSM	DATE	21-07-2022
APPROVED	DMM	DATE	26-07-2022
REVISION	-		

DRAWING NUMBER

WSC3X-XXXX

DESCRIPTION

WASHER 3" SQUARE CURVED