

SR NO	PART NUMBER	DESCRIPTION	L (INCH)	D (INCH)	T (INCH)	S (INCH)	WEIGHT (LBS)
1	BM1202	BOLT MACHINE 1/2" X 2" HDG SQUARE HEAD & NUT	2	1/2	1.25	3/16	0.18
2	BM1203	BOLT MACHINE 1/2" X 3" HDG SQUARE HEAD & NUT	3	1/2	2.5	3/16	0.21
3	BM1204	BOLT MACHINE 1/2" X 4" HDG SQUARE HEAD & NUT	4	1/2	3	3/16	0.32
4	BM1206	BOLT MACHINE 1/2" X 6" HDG SQUARE HEAD & NUT	6	1/2	3	3/16	0.41
5	BM1208	BOLT MACHINE 1/2" X 8" HDG SQUARE HEAD & NUT	8	1/2	4	3/16	0.52
6	BM1210	BOLT MACHINE 1/2" X 10" HDG SQUARE HEAD & NUT	10	1/2	4	3/16	0.6
7	BM1212	BOLT MACHINE 1/2" X 12" HDG SQUARE HEAD & NUT	12	1/2	6	3/16	0.7
8	BM1214	BOLT MACHINE 1/2" X 14" HDG SQUARE HEAD & NUT	14	1/2	6	3/16	0.8
9	BM1216	BOLT MACHINE 1/2" X 16" HDG SQUARE HEAD & NUT	16	1/2	6	3/16	0.89

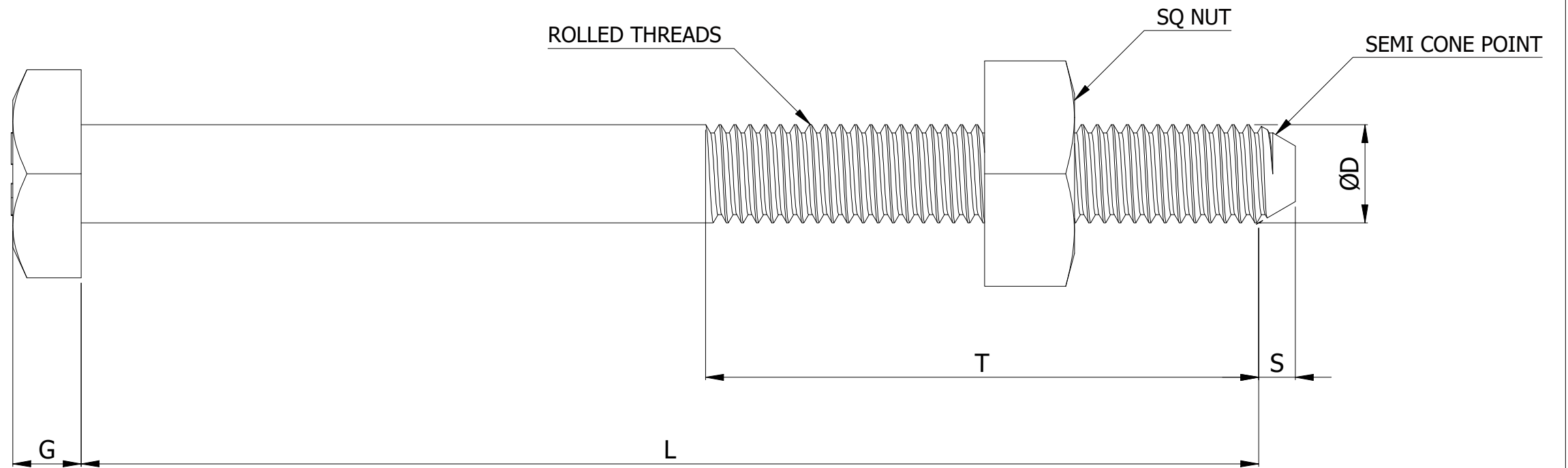
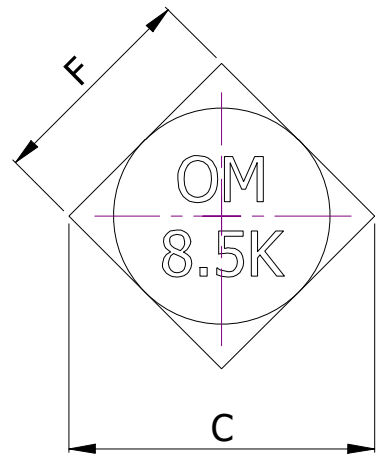

SQUARE BOLT HEAD DIMENSIONS

BOLT SIZE	- NOM.	F MIN.	- MAX.	C MIN.	C MAX.	- NOM.	G MIN.	- MAX.
1/2"	3/4"	0.725"	0.750"	0.995"	1.061"	21/64"	0.308"	0.348"

NOTES:-
 MATERIAL: ANSI C135.1
 MINIMUM TENSION STRENGTH 8,500 LBS
 GALVANIZED AS PER ASTM A153
 DIMENSIONS: BOLT - ANSI C135.1,
 SQ. NUT - ANSI B18.2.2 & ANSI C 135.1
 THREADS: UNC CLASS - 2, ANSI B.1.1 & CONFORM TO ANSI C135.

THIS DRAWING CONTAINS CONFIDENTIAL INFORMATION AND IS THE EXCLUSIVE PROPERTY OF ORBIS MANUFACTURING



DRAWN	MSM	DATE	26-07-2022
APPROVED	DMM	DATE	02-08-2022
REVISION	-		

DRAWING NUMBER	BM12XX
DESCRIPTION	BOLT MACHINE 1/2" X L" HDG SQUARE HEAD & NUT